

DB1: Main Consumer Unit		Location: GF 07	
Supply Source: DNO Fuse & Meter, L1			
Phases: L1			

RCD 1: 30mA		Circuit		Phase	MCB Size	Conductor Size	CPC Size
1	Cooker & Hob	L1	32	2.5	2.5		
2	Ring B - GF04, GF05	L1	32	2.5	2.5		
3	Ring D - 1F03, 1F07, 2F01	L1	32	2.5	1.5		
4	Immersion Heater - 1F09	L1	16	2.5	1.5		
5	GF Heating/ Back Boiler Pump - GF06	L1	6	2.5	1.5		
6	Lights A - GF01, GF02, GF06, GF07	L1	6	1.5	1.0		
7	Lights C - GF08, GF09	L1	6	1.5	1.0		
8	Lights E - 1F04, 1F05, 2F01	L1	6	1.5	1.0		
-	-	-	-	-	-	-	-
-	-	-	-	-	-	-	-
-	-	-	-	-	-	-	-

RCD 2: 30mA		Circuit		Phase	MCB Size	Conductor Size	CPC Size
9	Ring A - GF01, GF02, GF06, GF07	L1	32	2.5	1.5		
10	Ring C - GF08, GF09	L1	32	2.5	1.5		
11	Ring E - 1F01, 1F04, 1F05	L1	32	2.5	1.5		
12	Shower Pump - 1F09	L1	16	2.5	1.5		
13	1F Heating/ Gas Boiler - GF07	L1	6	2.5	1.5		
14	Lights B - GF04, GF05	L1	6	1.5	1.0		
15	Lights D - 1F01, 1F03, 1F06, 1F07, 1F08	L1	6	1.5	1.0		
16	Smokes - GF02, GF04, GF08, 1F01	L1	6	1.5	1.0		
-	-	-	-	-	-	-	-
-	-	-	-	-	-	-	-
-	-	-	-	-	-	-	-

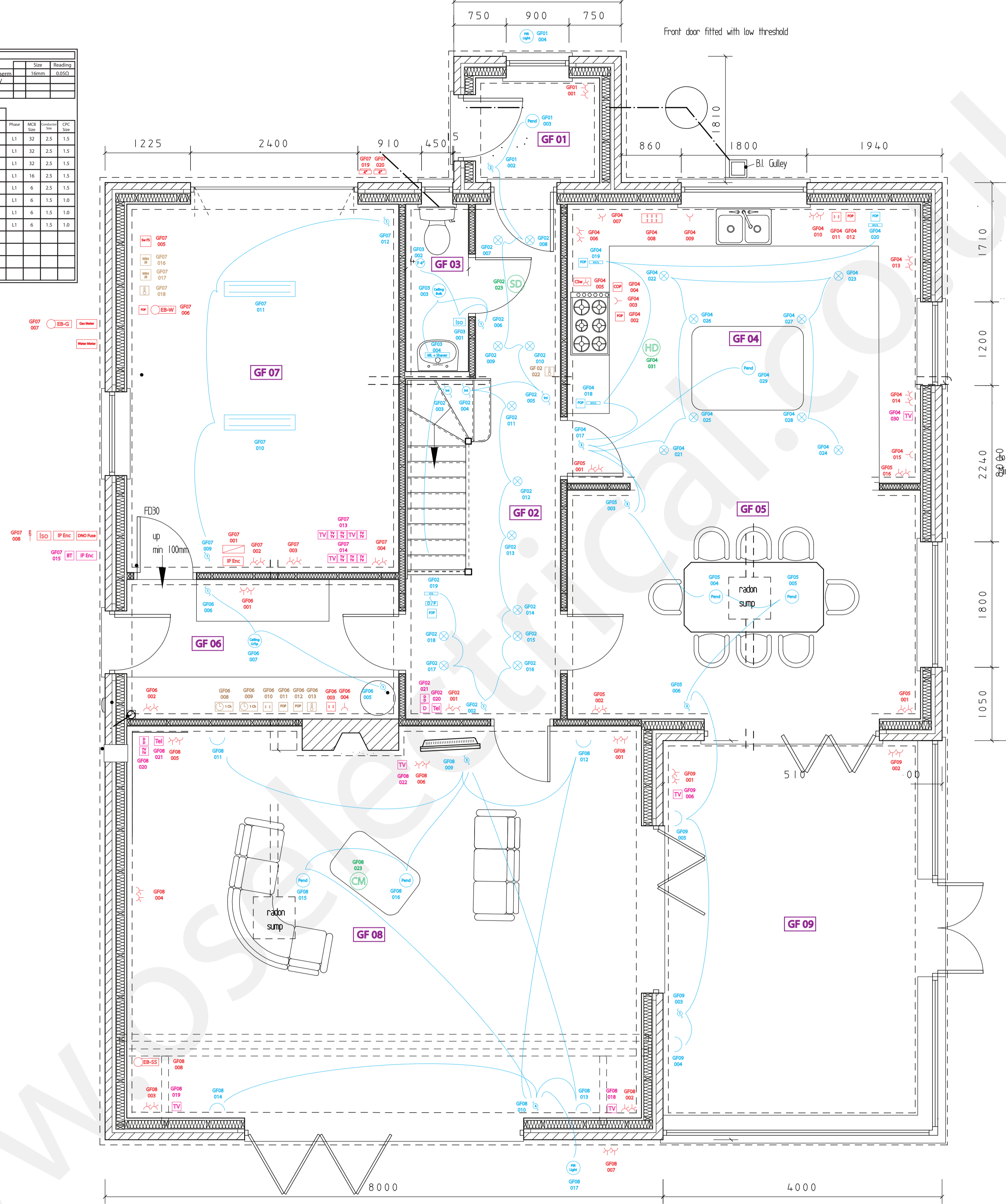

**Client Actions To Be Taken From This Drawing**

Key	
<b>Power &amp; Distribution</b>	<b>Lighting</b>
<ul style="list-style-type: none"> <li>1 Phase/ 3 Phase Fuse Board</li> <li>DNO Fuse (Western Power)</li> <li>Earth Electrode</li> <li>Gas Meter</li> <li>Water Meter</li> <li>Earth Bond/ Water/ Gas/ Solar Therm</li> <li>Earth Bond/ Oil/ Steel/ Solar PV</li> <li>13A Double Socket</li> <li>13A Single Socket/ Sw/ Unswitched</li> <li>Switched Fuse Spur</li> <li>Flex Outlet 20A / Cooker Outlet 45A</li> <li>Cooker Switch &amp; Skt</li> <li>Isolator/ Fan Isolator</li> <li>Grid Plate 2G/ 3G/ 4G</li> <li>Grid Plate 6G/ 8G</li> <li>Fan 4"/ Fan 6"/ Fan Inline</li> <li>Shaver Point</li> <li>Thermostat/ Timeclock 1/2 Channel</li> <li>Wiring Centre (MIB4)</li> <li>IP Rated Enclosure</li> <li>External Fan Grille 4" / 6"</li> </ul>	<ul style="list-style-type: none"> <li>Spot Light/ IP 65/ IP 67/ 12 Volt/ LED</li> <li>Pendant/ Batten Holder</li> <li>Peelme/ Wall Light</li> <li>Single/ Double Fluorescent Light</li> <li>Ceiling Bulkhead/ 2D Light/ Track</li> <li>Light Un-Specified/ Ceiling/ Wall</li> <li>Mirror Light/ + Shaver Skt</li> <li>Cupboard/ Under Cupboard Light</li> <li>PIR Light</li> <li>Sensor/ PIR/ Motion</li> <li>Socket Faceplate/ 2A/ 5A</li> <li>Switch/ 1, 2, 3 Gang/ Intermediate</li> <li>Switch/ Door Push/ Pull Cord</li> </ul>
<b>Safety</b>	<b>Media</b>
<ul style="list-style-type: none"> <li>Smoke/ Heat/ CO Detector</li> </ul>	<ul style="list-style-type: none"> <li>Monor/ Stereo Speaker Plate</li> <li>BT External Connection</li> <li>Telephone Socket</li> <li>Single/ Double Data Socket</li> <li>Single/ Double TV / Coax</li> <li>Digital TV Aerial</li> <li>HDMI</li> </ul>

**\*\*\* AS FITTED - COMPLETED INSTALLATION \*\*\***  
 DO NOT SCALE FROM THIS DRAWING. DRAWING FOR ILLUSTRATION ONLY.  
 ALL MEASUREMENTS TO BE TAKEN ON SITE.  
 ILLUSTRATED LAYOUT OF THIS PROPERTY HAS BEEN TAKEN FROM ARCHITECT PLANS.  
 ORIGINAL PLANS ARE COPYRIGHT OF THE ARCHITECT

Correspondence Address: O.S Electrical New Installation Example Plans Cornwall	Works & Delivery Address: O.S Electrical New Installation Example Plans Cornwall
Telephone : Mobile : Email :	Telephone : Mobile : Email :

DRAWING CONTENT		
Drawing #: GF Heating 005	Drawing Title: As Fitted	Drawing Date: 05/02/2013
Drawing #: GF Lighting 005	Drawing Title: As Fitted	Drawing Date: 05/02/2013
Drawing #: GF Media 005	Drawing Title: As Fitted	Drawing Date: 05/02/2013
Drawing #: GF Power 005	Drawing Title: As Fitted	Drawing Date: 05/02/2013
Drawing #: GF Safety 005	Drawing Title: As Fitted	Drawing Date: 05/02/2013
Drawing #:	Drawing Title:	Drawing Date:
Size:	Scale:	Designer:

Height Specifications. All Measurements From Assumed Finished Floor Level (FFL)					
Electrical & AV Sockets	Light Switches	Multi-Room Audio/ Media Keysets	Thermostats	Security Keysets	Consumer Units/ DBs
Standard	Worktop	Bedside	Standard	Bedside	Standard
1000mm	1000mm	1000mm	1000mm	1000mm	1000mm

**o. s. electrical**  
 5B trelawney av. st. ives, cornwall, tr26 1as  
 e: info@oselectrical.co.uk | t: 01736 797417  
 m: 07816067921 | www.oselectrical.co.uk

